

My search [for the essence of sculpture] has been influenced by [...] how it fits into nature and how it relates to human beings.

- Isamu Noguchi

a journey of form

Linh Nguyen
INT 602-02
Professor Tetsu Ohara
Spring 2022

The proposed akari showroom is a celebration of **simple geometry** - the most basic shapes that were frequently employed by Isamu Noguchi in his works, especially his akari light sculptures. The showroom invites viewers to journey **between** clusters of light to witness the **evolution** and **spectrum** of akari **morphology** that lies between the **most basic shapes**.

To enhance viewers' understanding, the display system ensures each sculpture's **applicable** position, **visibility** and **reachability**. Richlite panels, which share the akari sculptures' **warmth** and **paper microtexture**, are the main component of the display system, thereby **magnifying** the sculptures' tactile qualities.

As building blocks, right triangle and square Richlite panels were selected for their **economical use of material**. The panels' **infinite combinations**, **multiple applications**, and **disassemblability** unify and **diversify the usage** of the space.

GEOEMETRIC LAND PLOTS

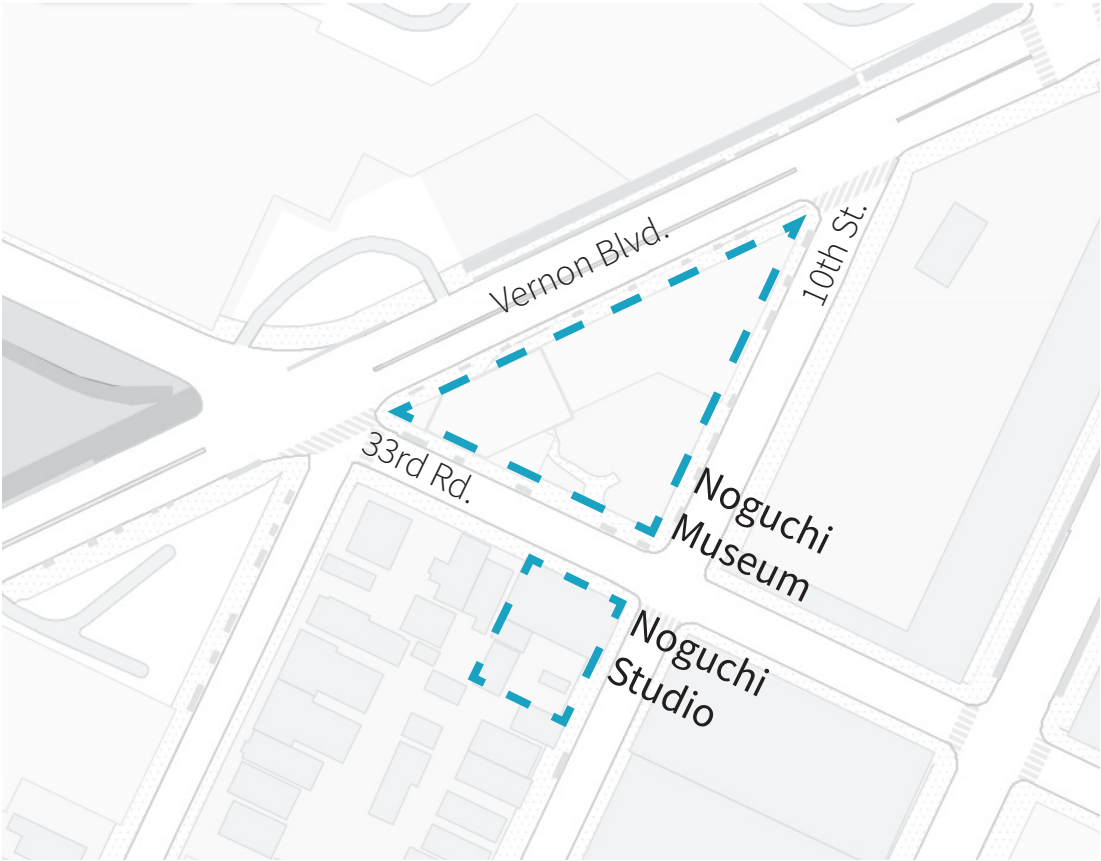

INCONSPICUOUS EXTERIOR

Surrounding buildings



Noguchi Studio



Commonalities:

- Low-rise
- Material: brick, steel
- Colours: brick red, beige/ grey, metallic
- Clerestory windows

MOVABLE PARTITION SYSTEM

This multi-axis movable, rotatable, lockable partition system was a collaboration between Buckminster Fuller, Edward Prince, and Noguchi.

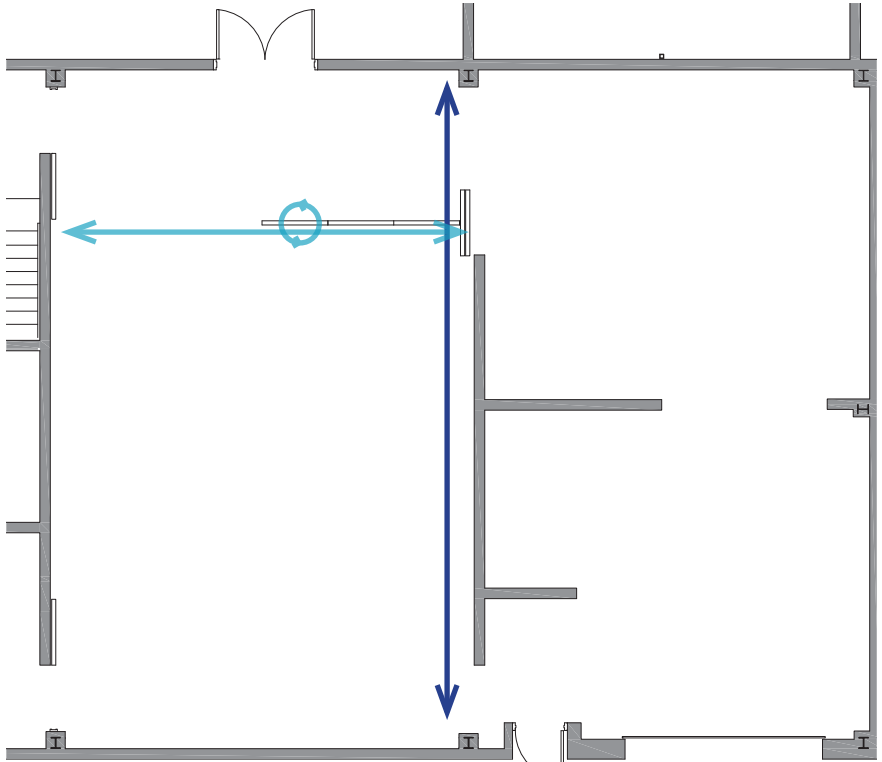

Motion capacity of partition system

INSULATION CAPACITY

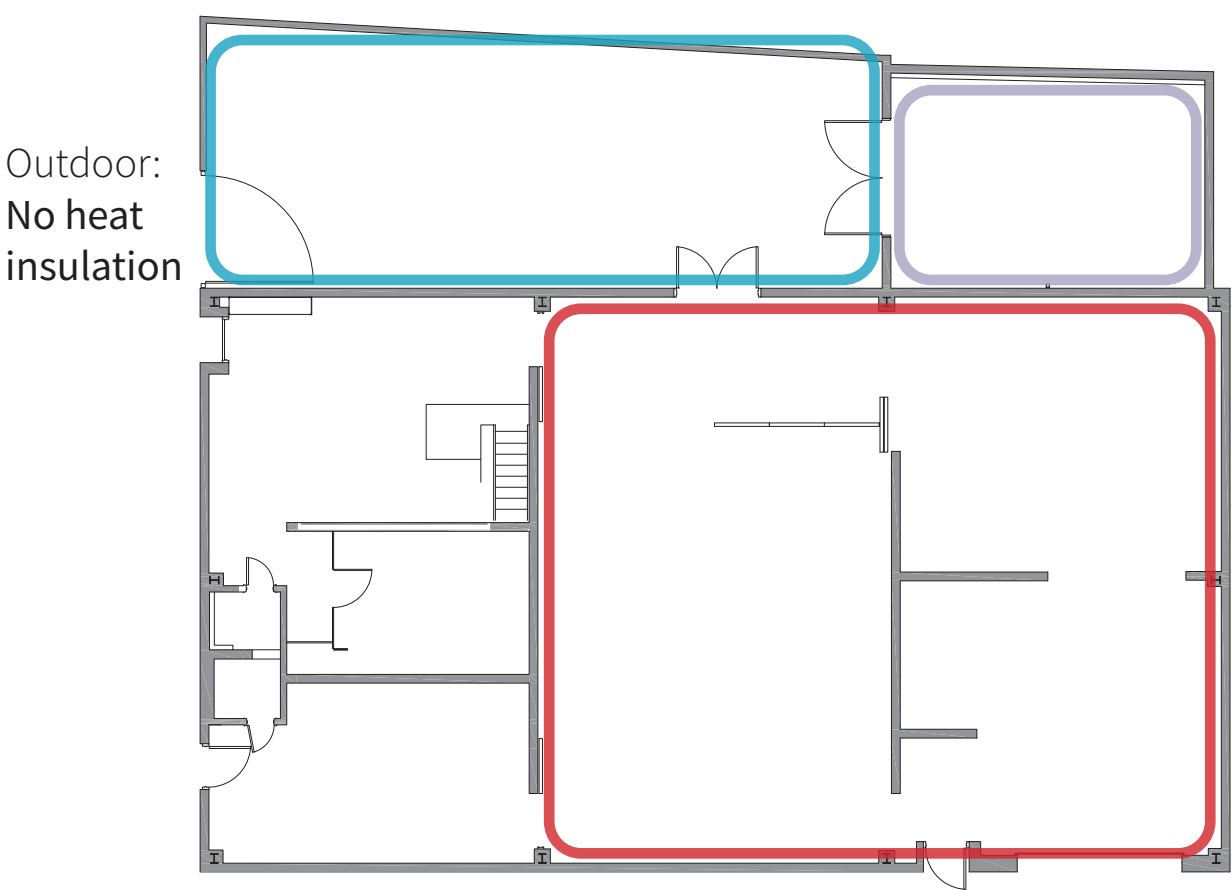

Outdoor:
No heat
insulation

Wooden walls &
large skylight:
**Poor heat
insulation**

CMU & brick wall:
**Best heat
insulation**

CONCEPT DRIVERS

ZAZEN

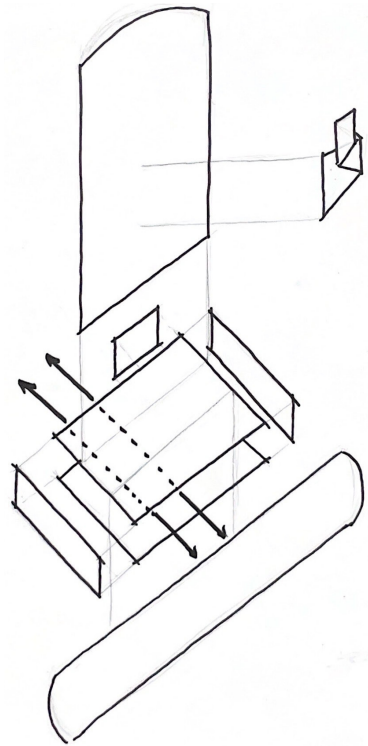
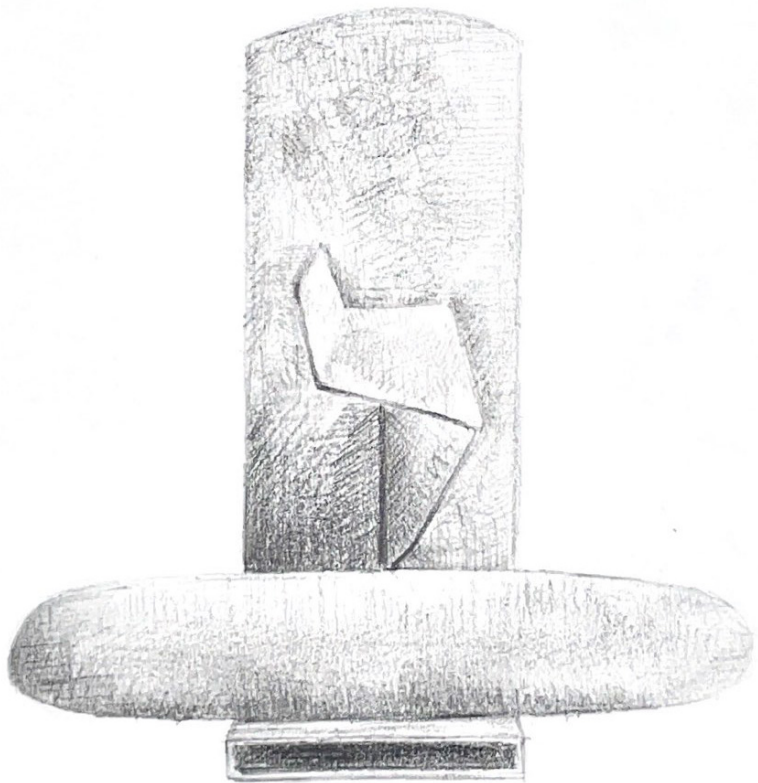

ROTATION FOR REVELATION

AKARI YP1

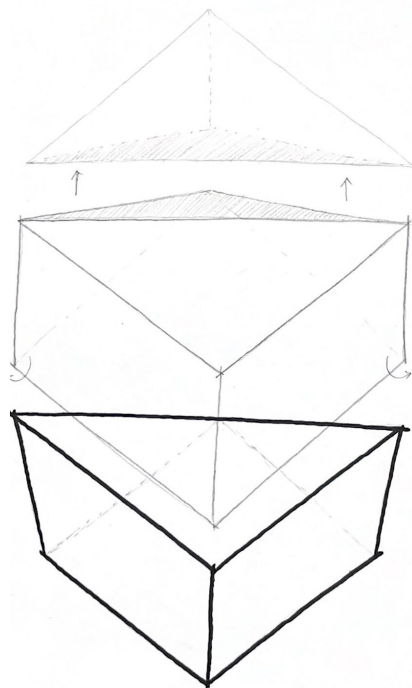

GEOMETRY OF AKARI

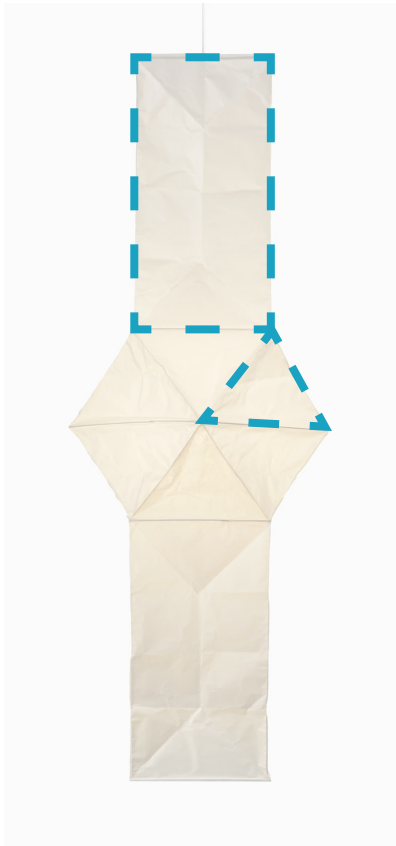
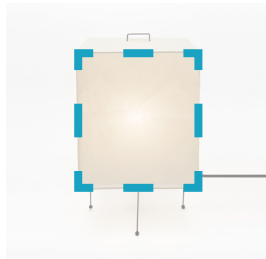

NOGUCHI'S PLAYGROUNDS



Isamu Noguchi, Riverside Playground: Play Terrace Study, c. 1961 (cast 1963). Bronze. Photo: Kevin Noble.

DESIGN LANGUAGE

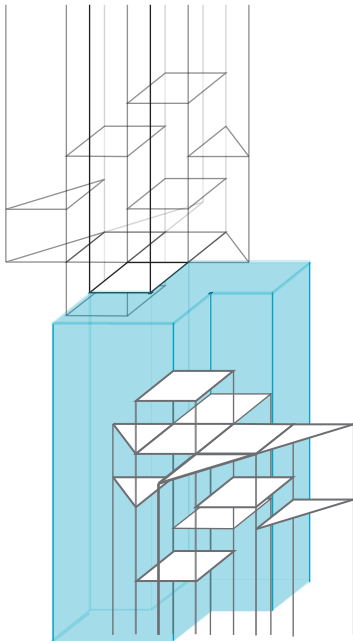
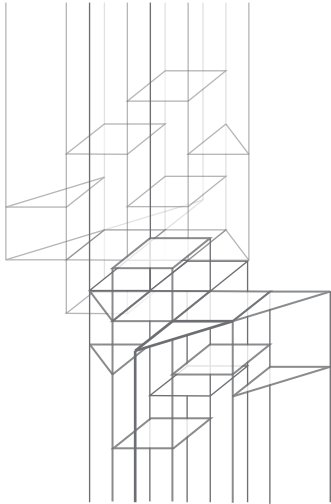
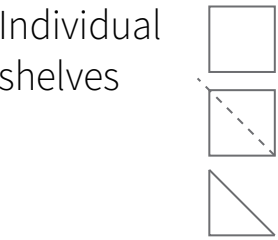

Accommodating ceiling akari

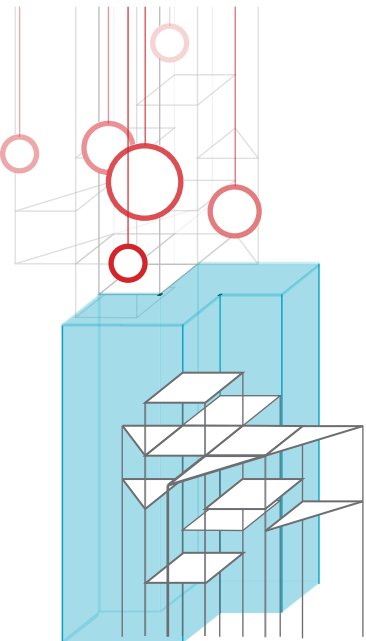

Accommodating table akari

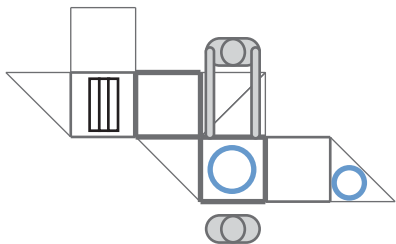

Accommodating floor akari

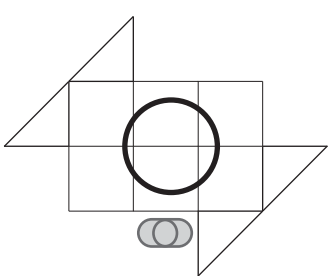
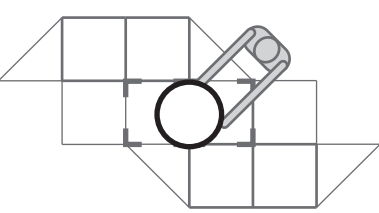
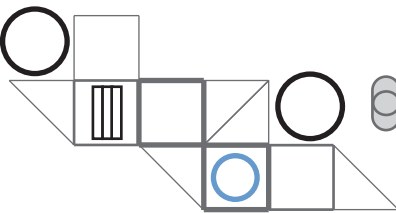

Diversifying circulation path

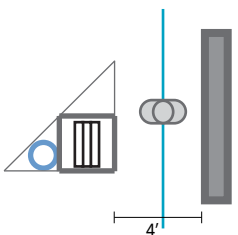
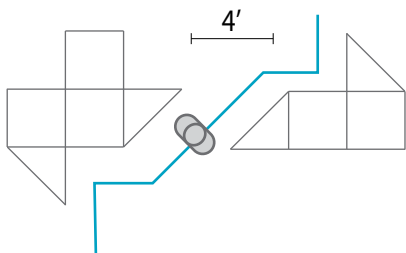
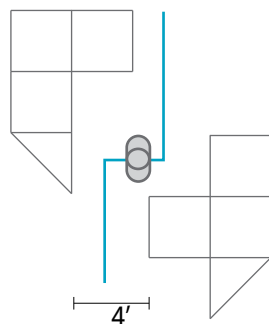
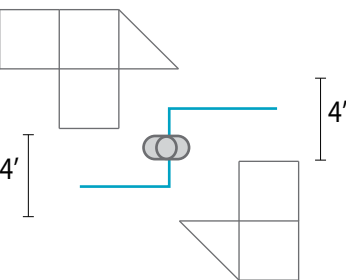
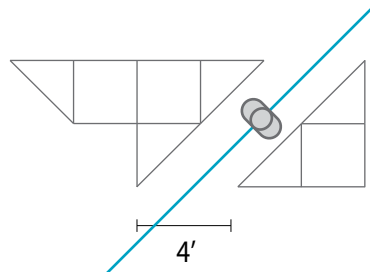

Accommodating different programs

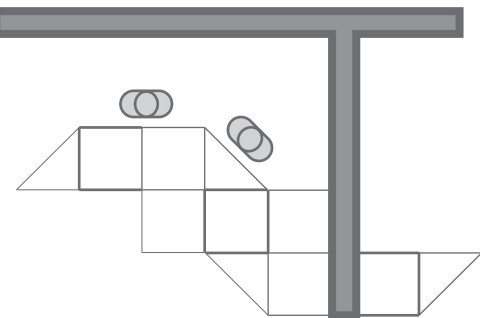
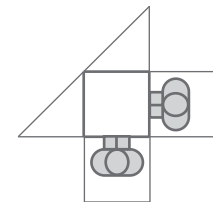

- Ceiling akari
- Table akari
- Floor akari
- Books

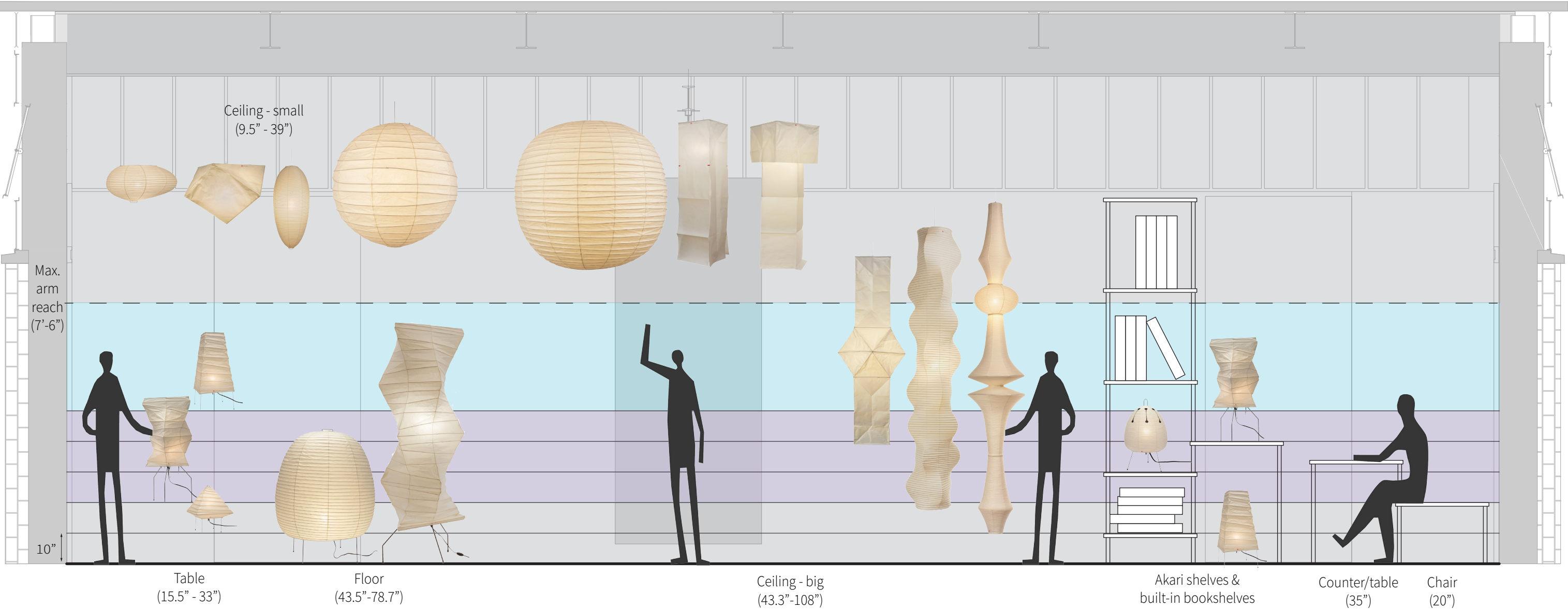

- Unreachable zone
- Eye- level, touchable zone
- Below eye-level, touchable zone
- Shelf levels, 10" apart



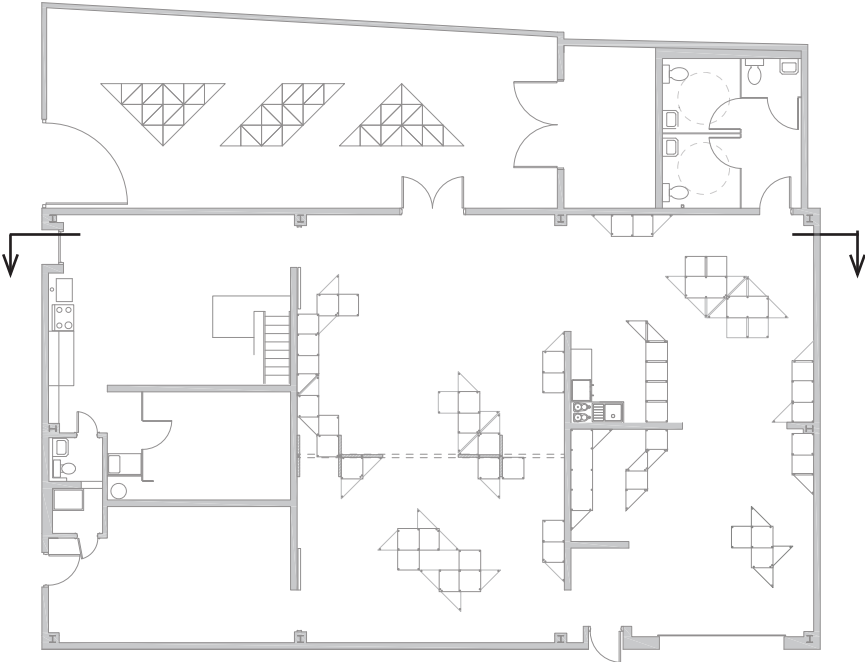

MECHANISM

0.25" peg that fits through pre-drilled hole to support Richlite panel above

1.5" reclaimed steel tubes with pre-drilled holes for pegs and cables

Concealed akari cable

0.5" dark green unpolished Richlite panel with pre-drilled corner holes

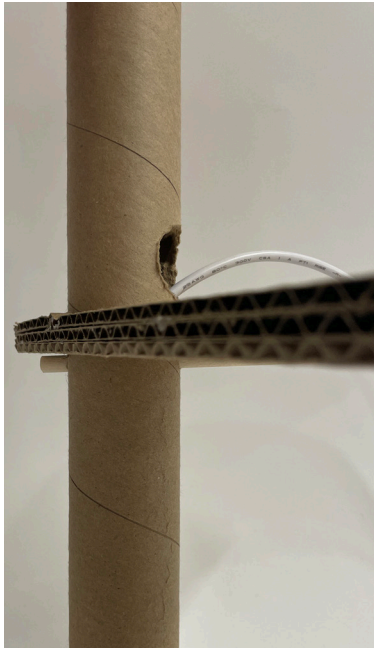

Mechanism mockup

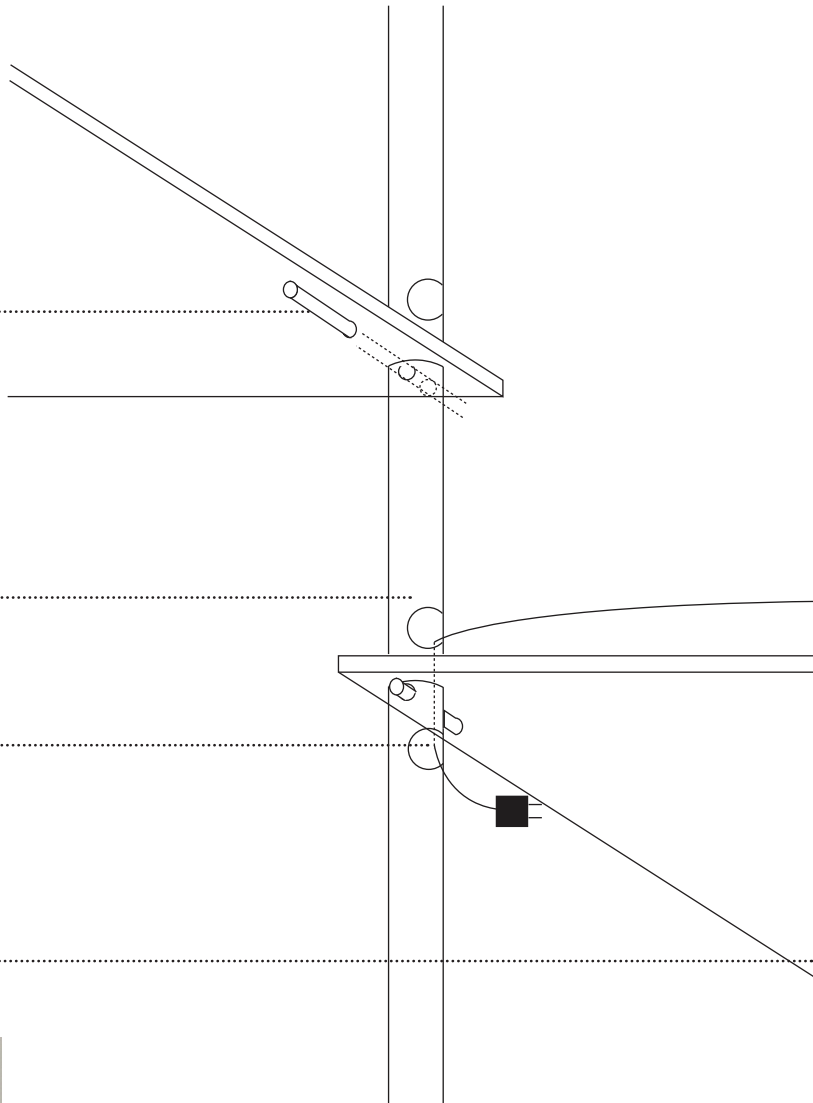

COMPONENT TAXONOMY

Individual panel shapes



Individual panel dimensions

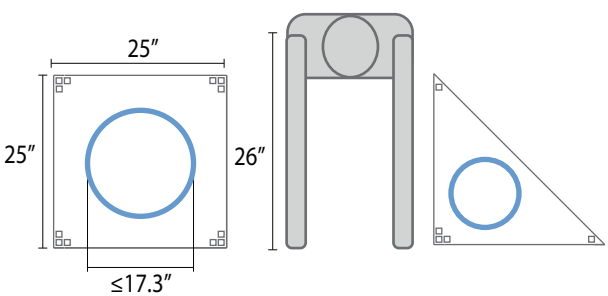

Clustering through overlapping

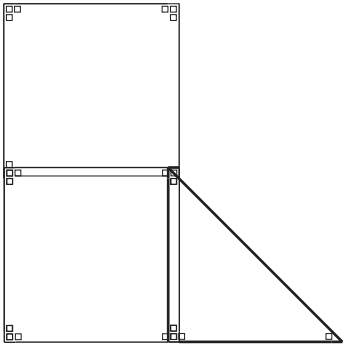

Thickness variation

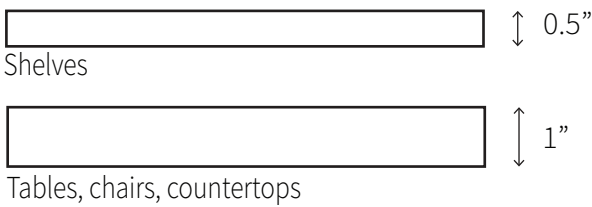

Steel tube variety

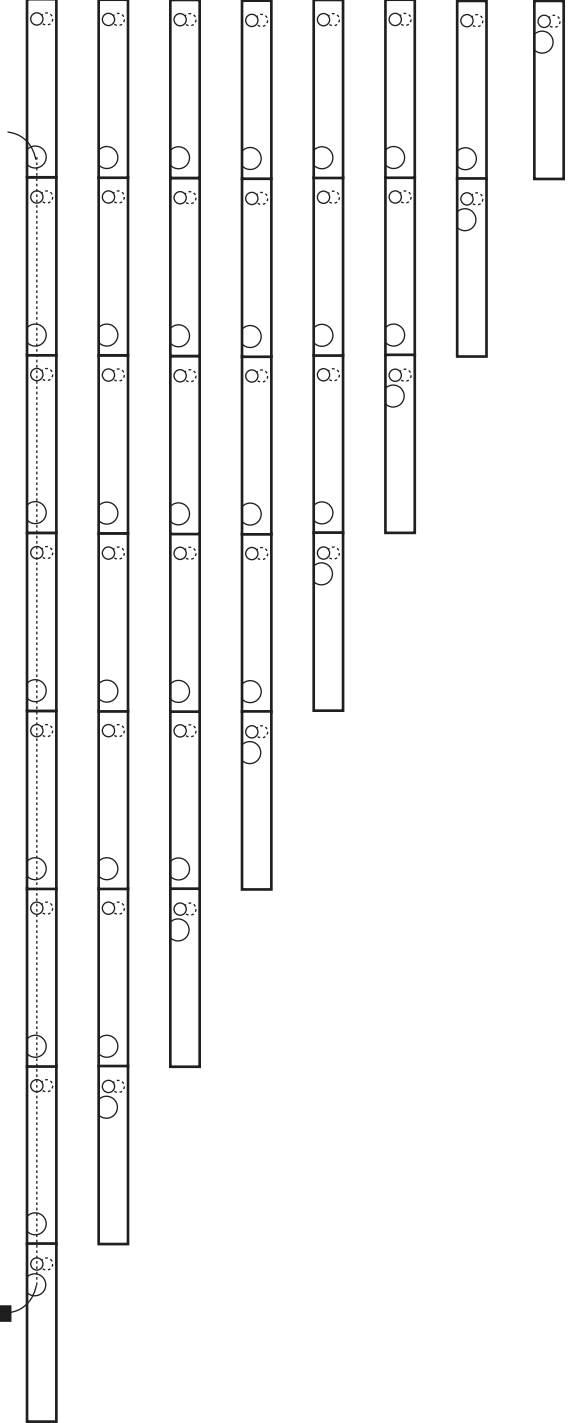

AKARI GROUPING BY FORM

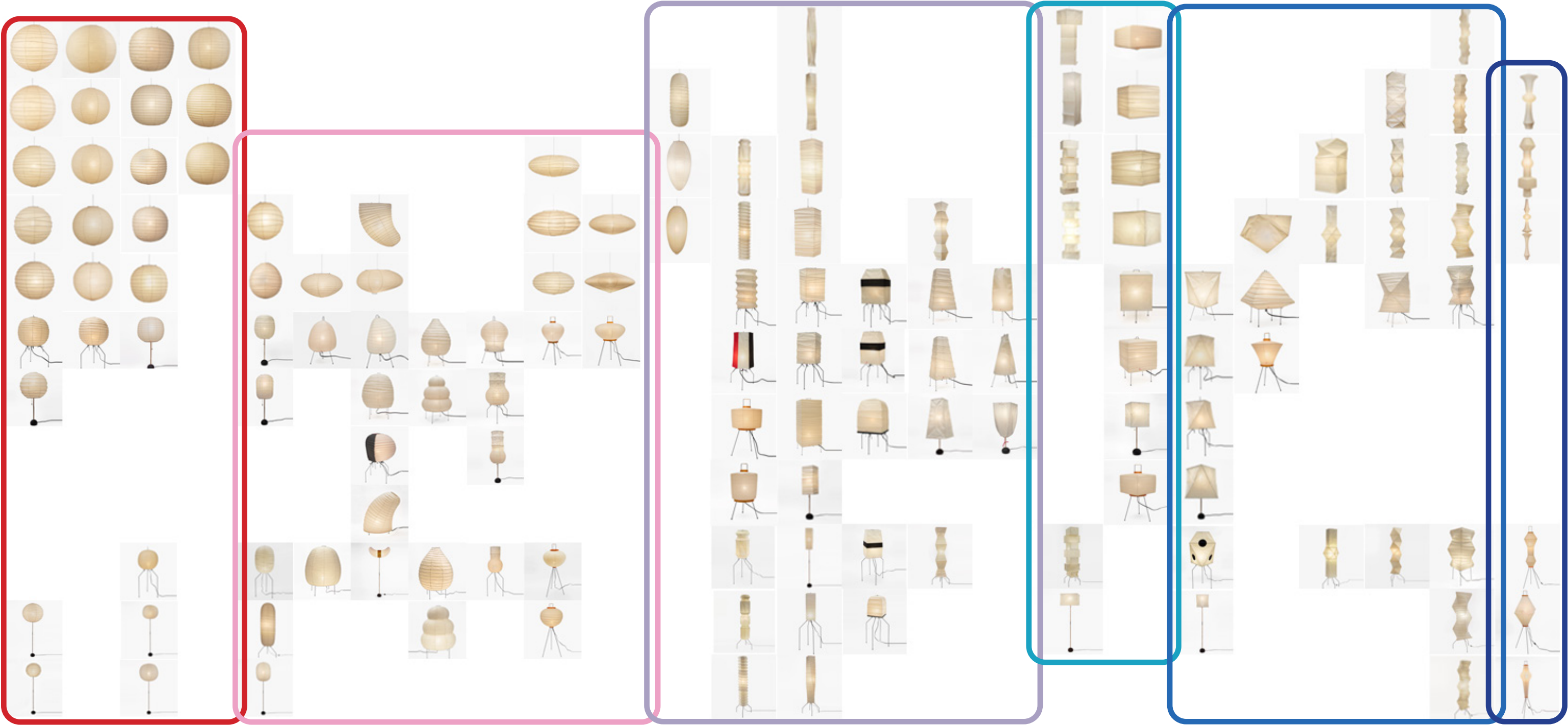

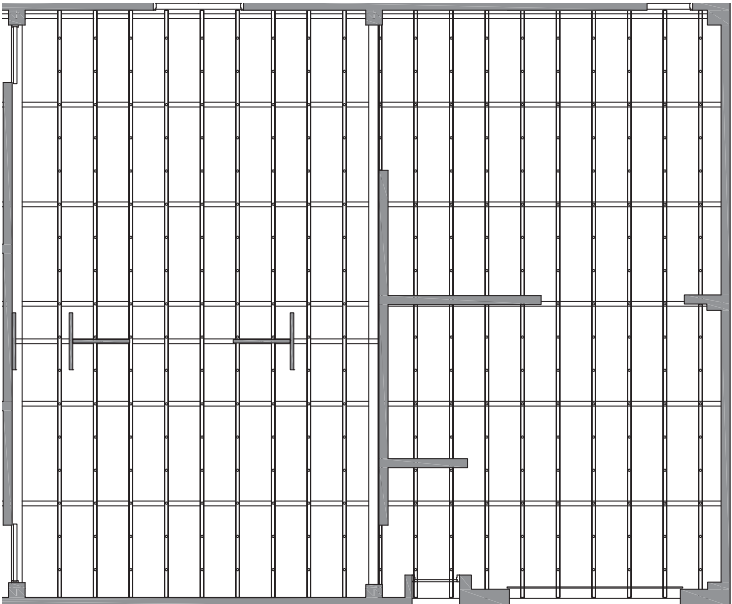

RCP showing added pre-punched beams

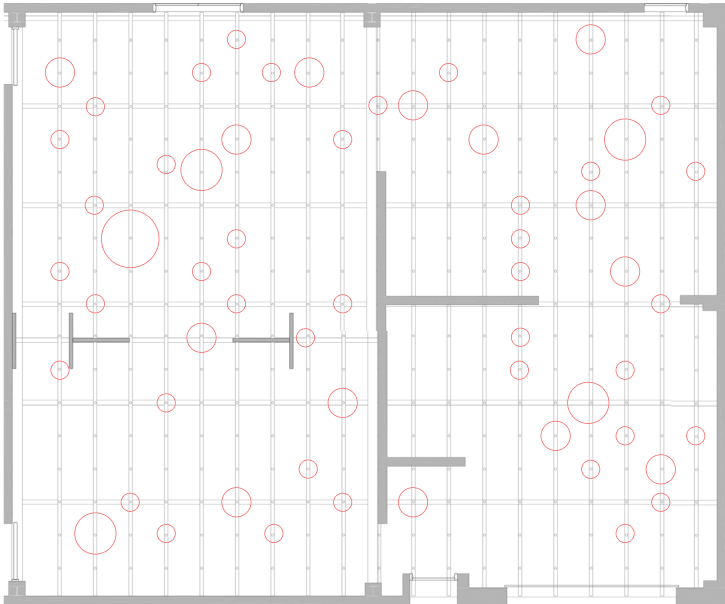

Distribution of ceiling akari (in RCP)

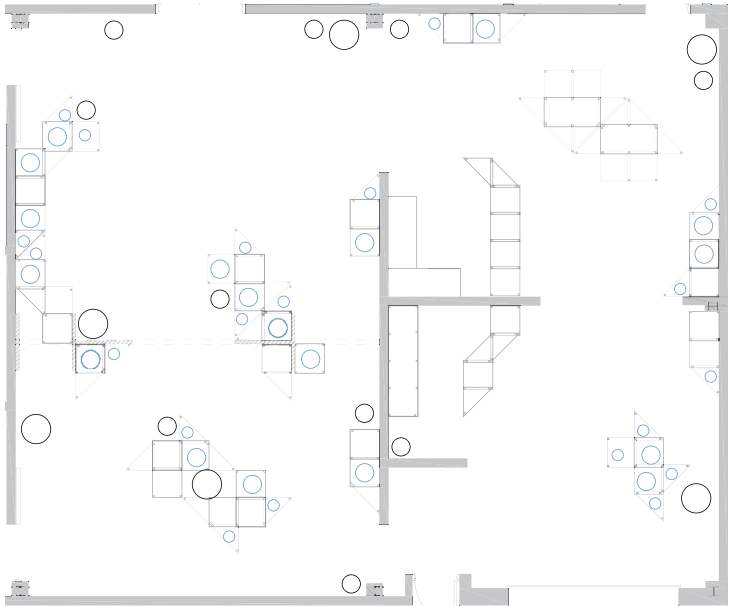

Distribution of floor & table akari (in plan)

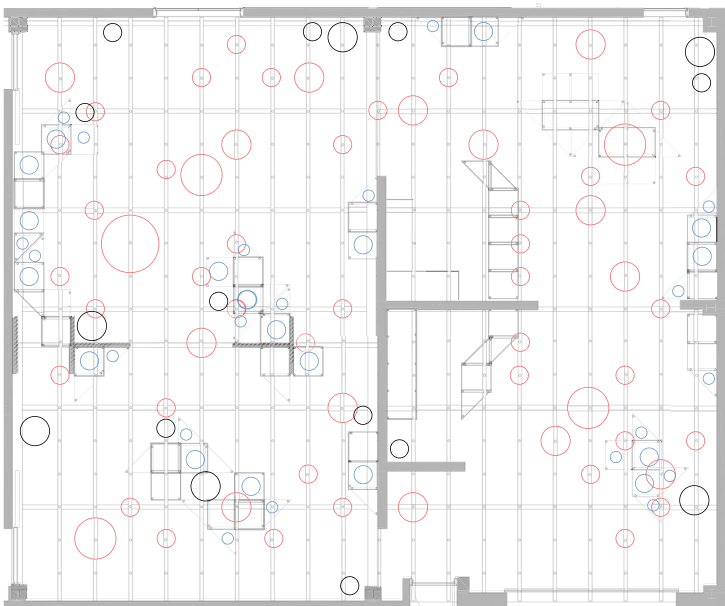

Distribution of all akari in site

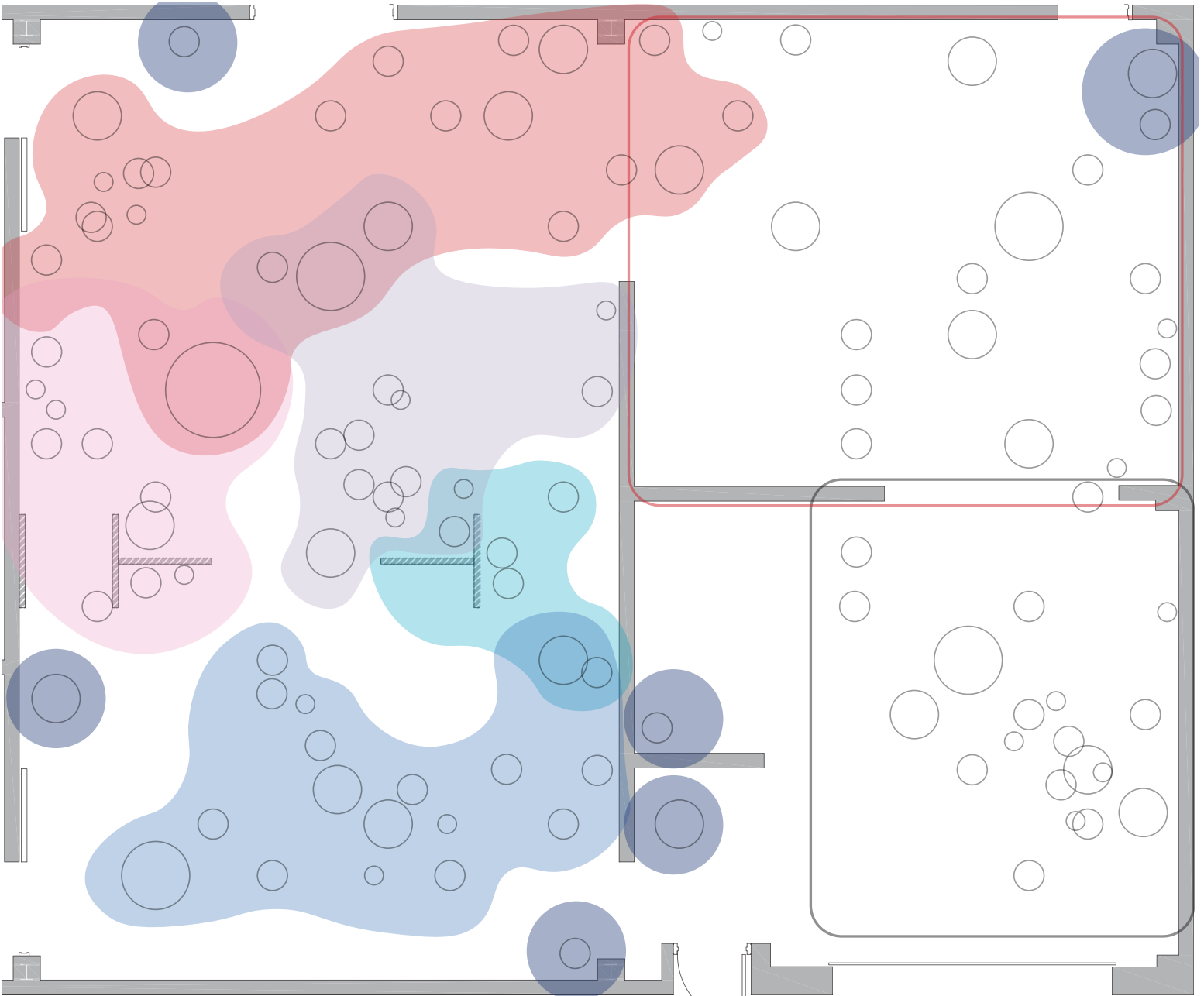

Distribution of all akari by form

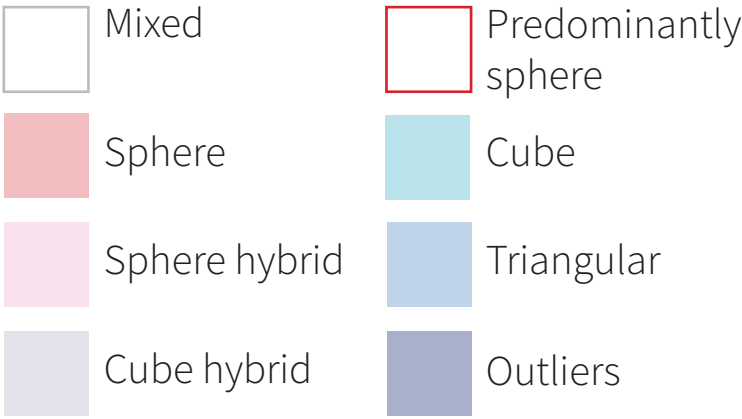

ENTRANCE

The **full catalog** of akari is projected onto existing CMU wall, and is visible both upon entrance and at the main showroom exit. Projection is used (instead of touch screen) for **community health** purpose.

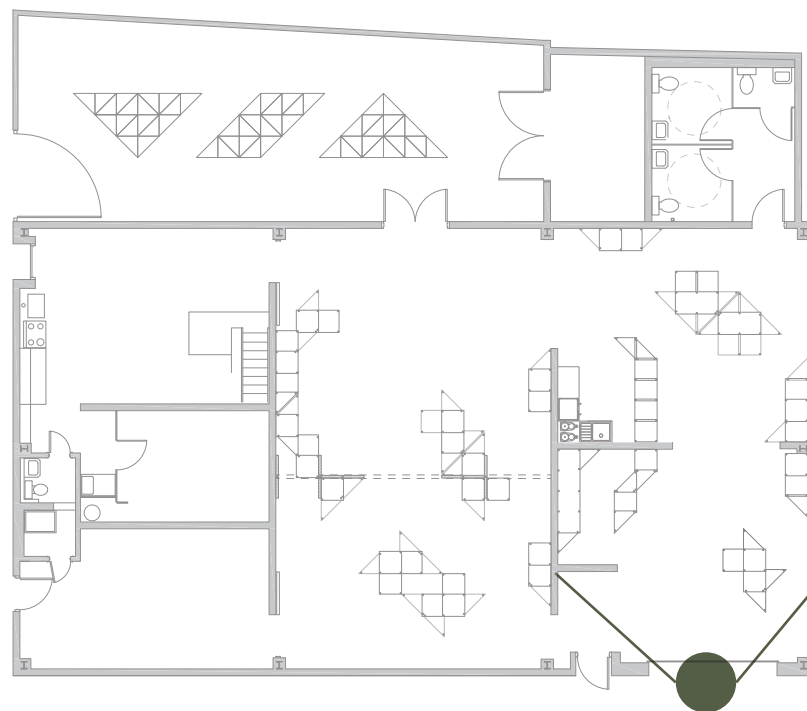

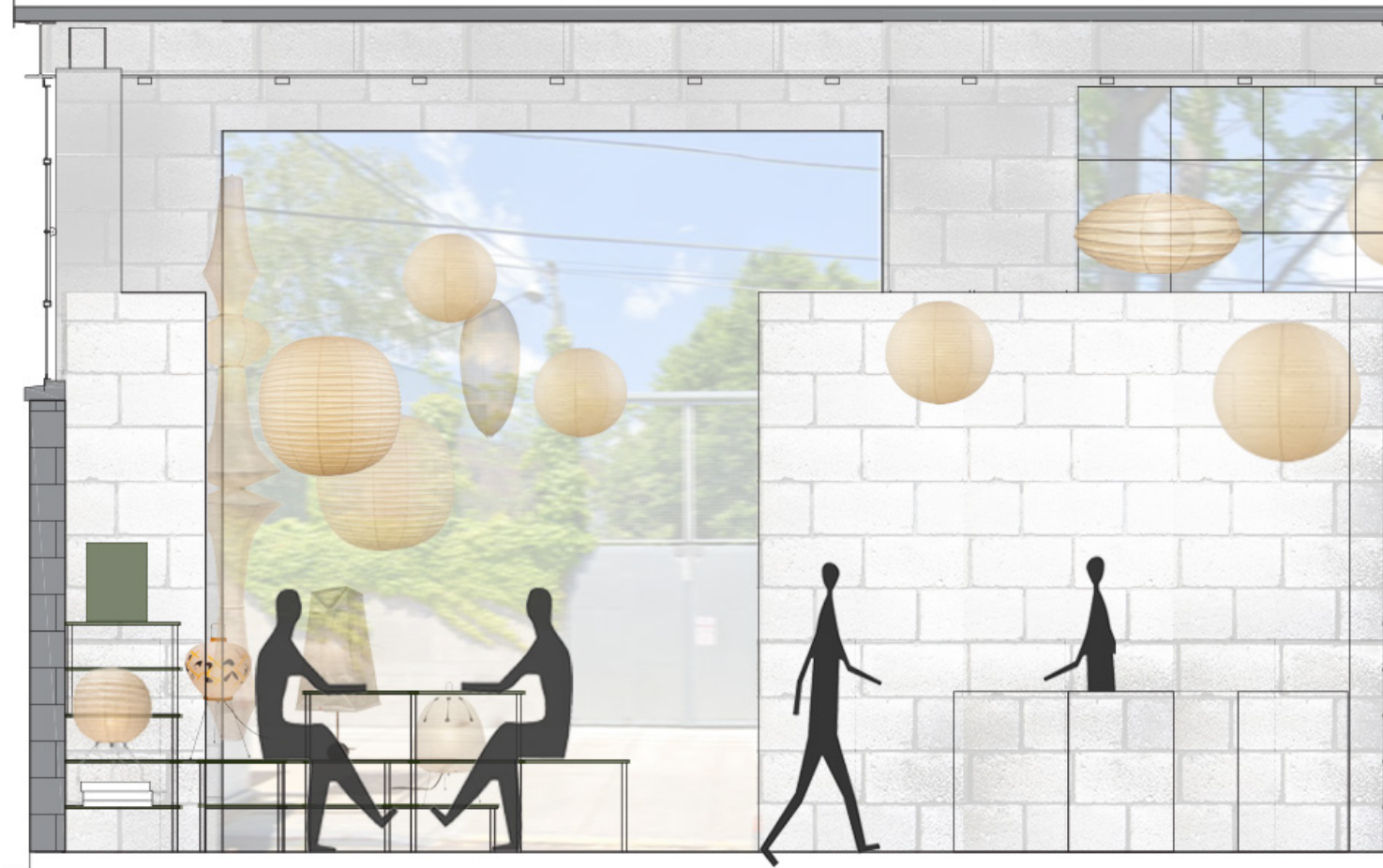

Section C: Indoor cafe seating



Section D: Outdoor cafe seating

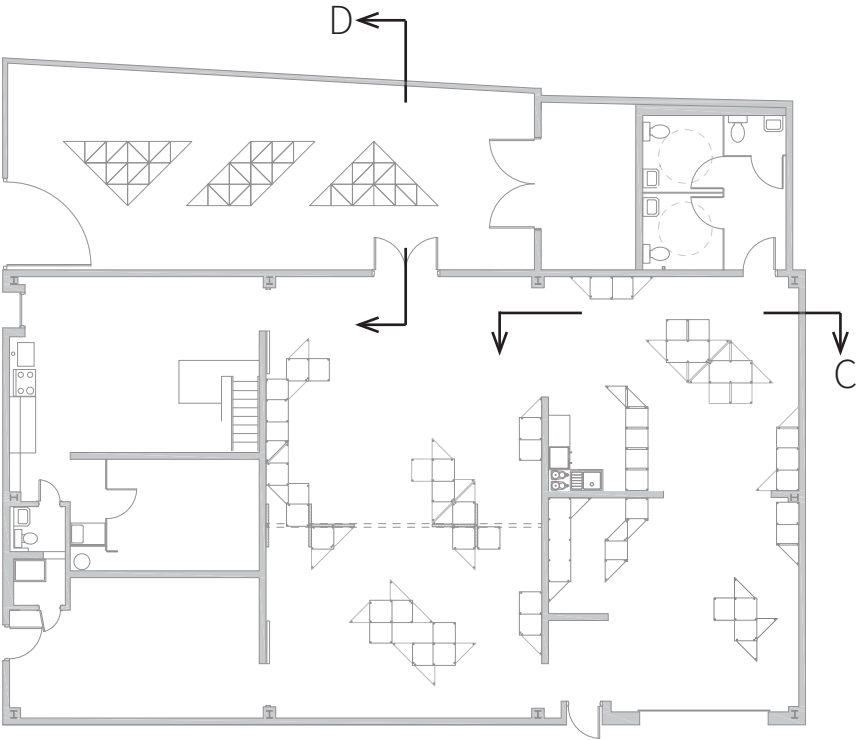



Section E: Main showroom section facing East

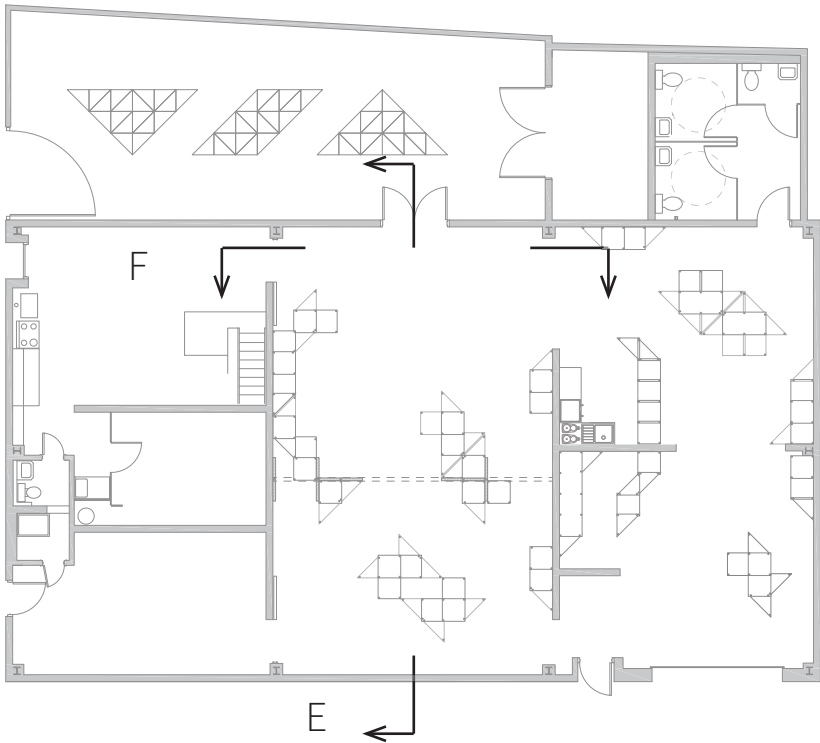

Section F: Main showroom section facing North

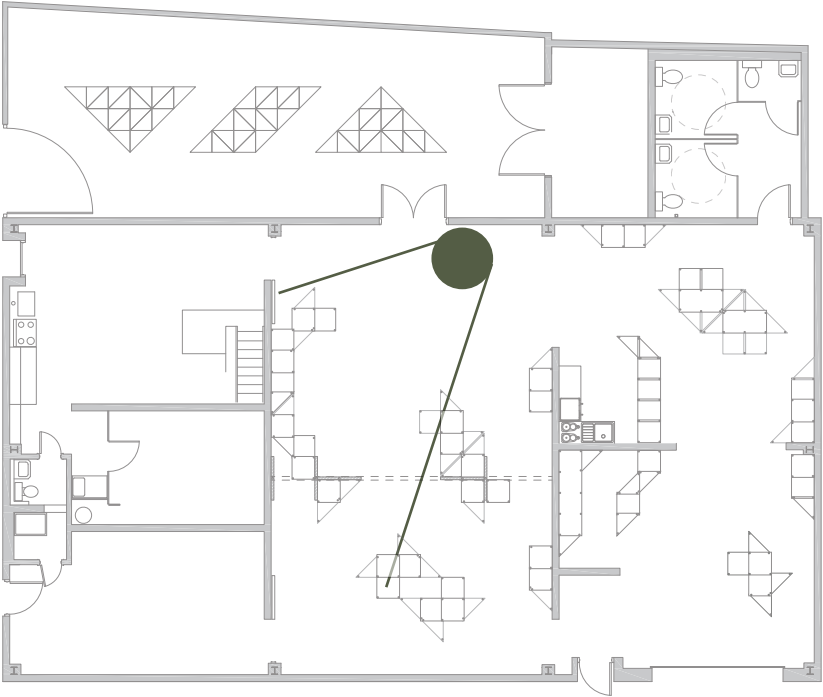

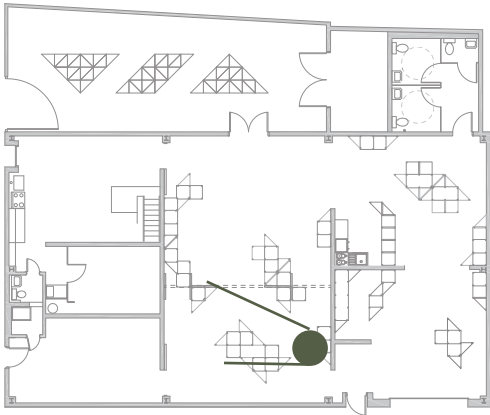

To emphasise the morphology transformation, **motion graphics** based on the basic akari shapes will be commissioned. They will be **combined with bite-size**, yet important pieces of **information** about or **descriptors** of akari. They will then be **projected** onto CMU walls or movable partitions. The graphics at each projection station will vary depending on the **the morphological transformation** taking place near it.

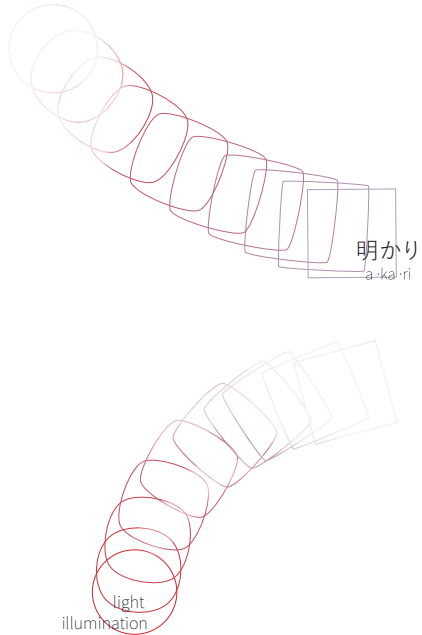

2 moments in sample motion graphic for highlighting spherical - cubic transformation

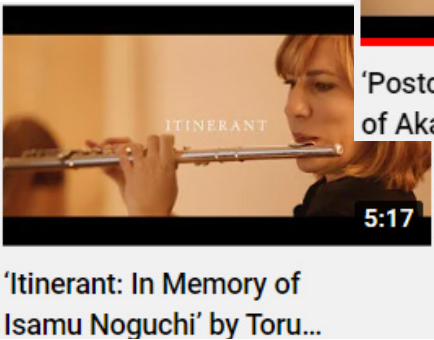
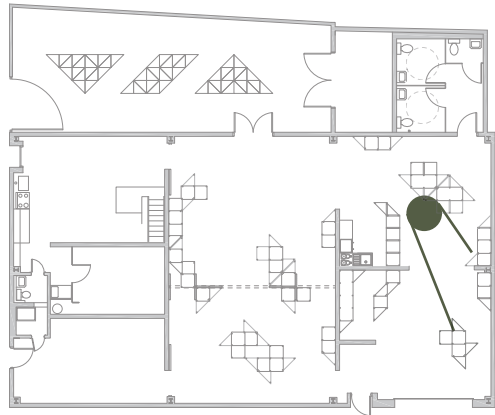

To tie in with the abstract nature of the the concept of morphology transformation, as well as the motion graphics, the sounds used to fill space would also be on the **abstract** side. Soundclips that exemplify this are “Postcards II Akari” and “Itinerant: In Memory of Isamu Noguchi,” both available on the Noguchi Museum’s Youtube channel.

MINIMIZING CLIMATE CONTROLLED AREA

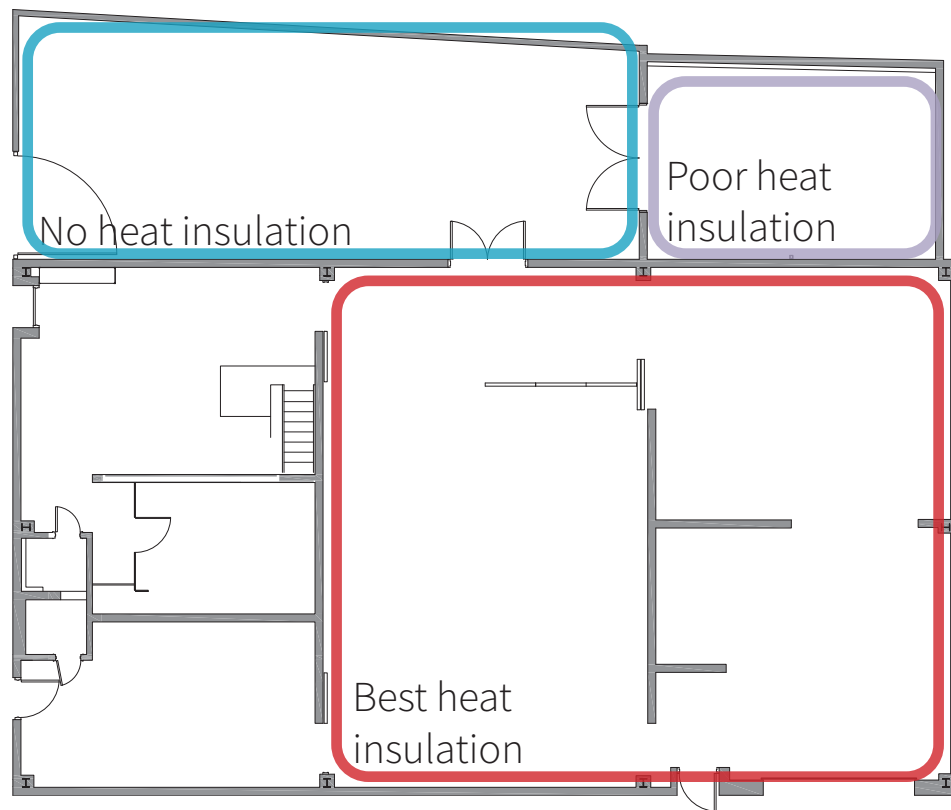

Heat retention capacity by zone

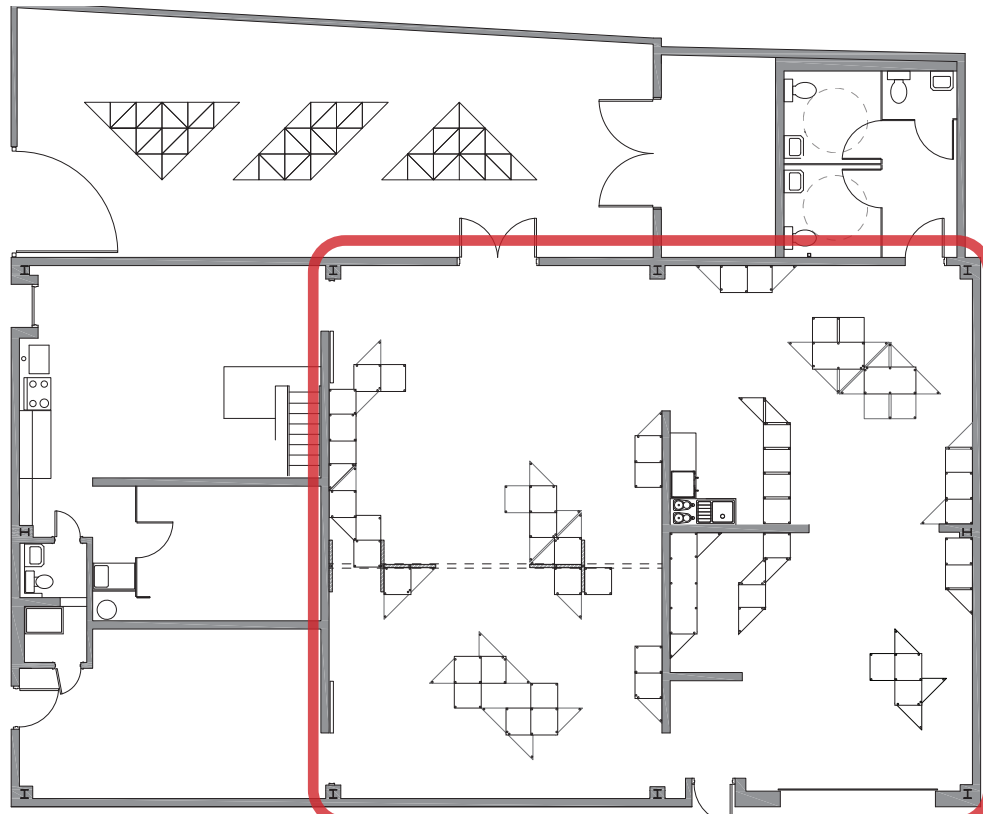

All programs requiring climate control are concentrated in zone with best heat insulation capacity

SUSTAINABLE MATERIALS

Richlite panels

- Composed of **recycled paper** & phenol resin
- Comes in a variety of colours and thickness
- Provides colour contrast with white akari sculpture
- Warm
- Retains paper texture
- Machinable
- **Durable**
- **Manufactured in the US,**
- **Heat loss during manufacturing process is recaptured and recycled**

Reclaimed steel tubes

- Structurally strong
- Can be refinished to meet retail display quality
- Can be pre-cut, pre-punched
- Available through many stockists

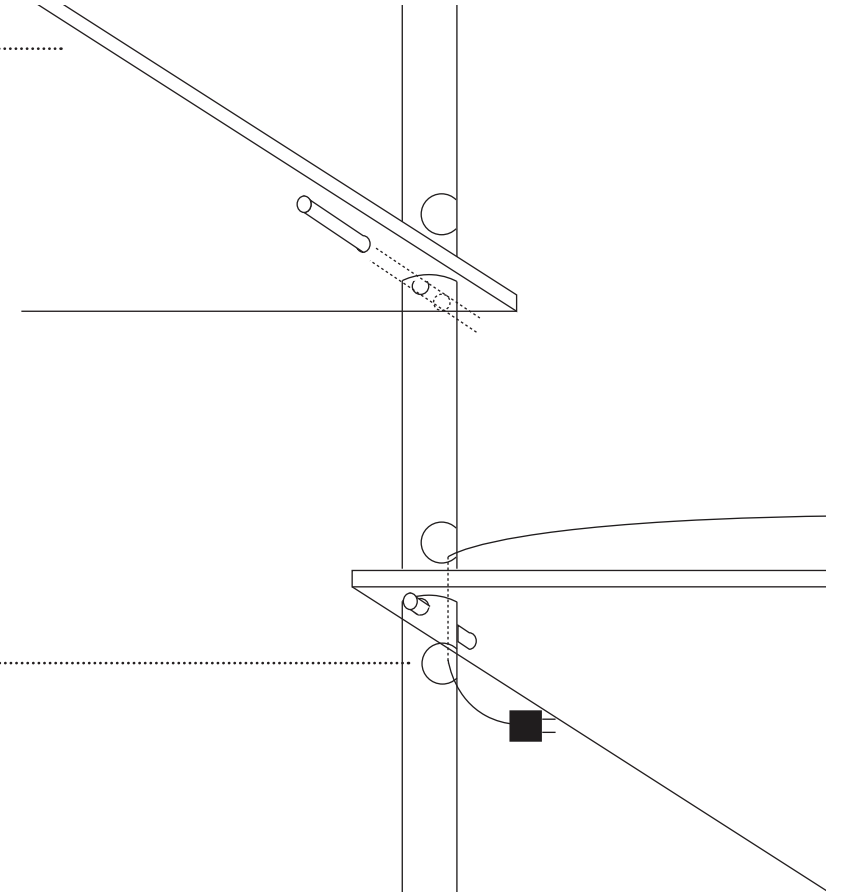

MINIMIZING MATERIAL WASTE

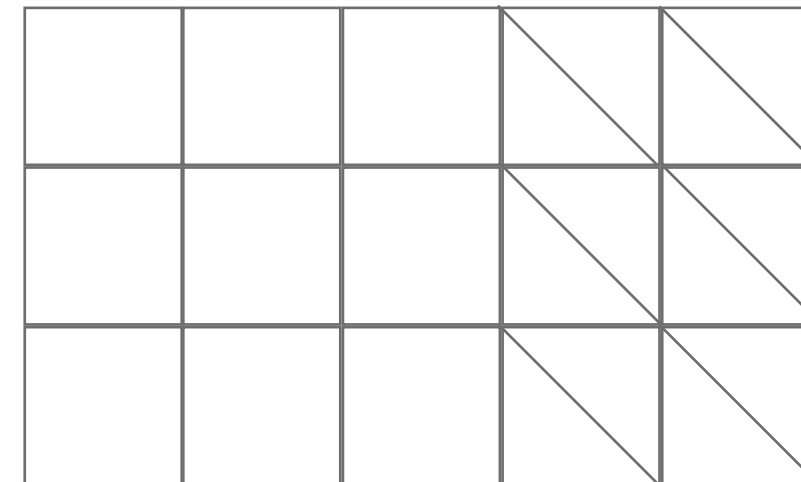
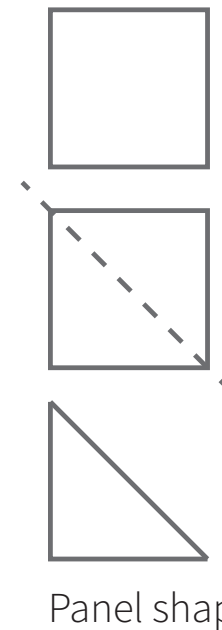

Sample panel cutting template

Within the display system, all square panels are 25" x 25", and all right triangle panels are half the size of square panels. As all orthogonal dimensions are 25", there will be minimal waste generated during the cutting process.

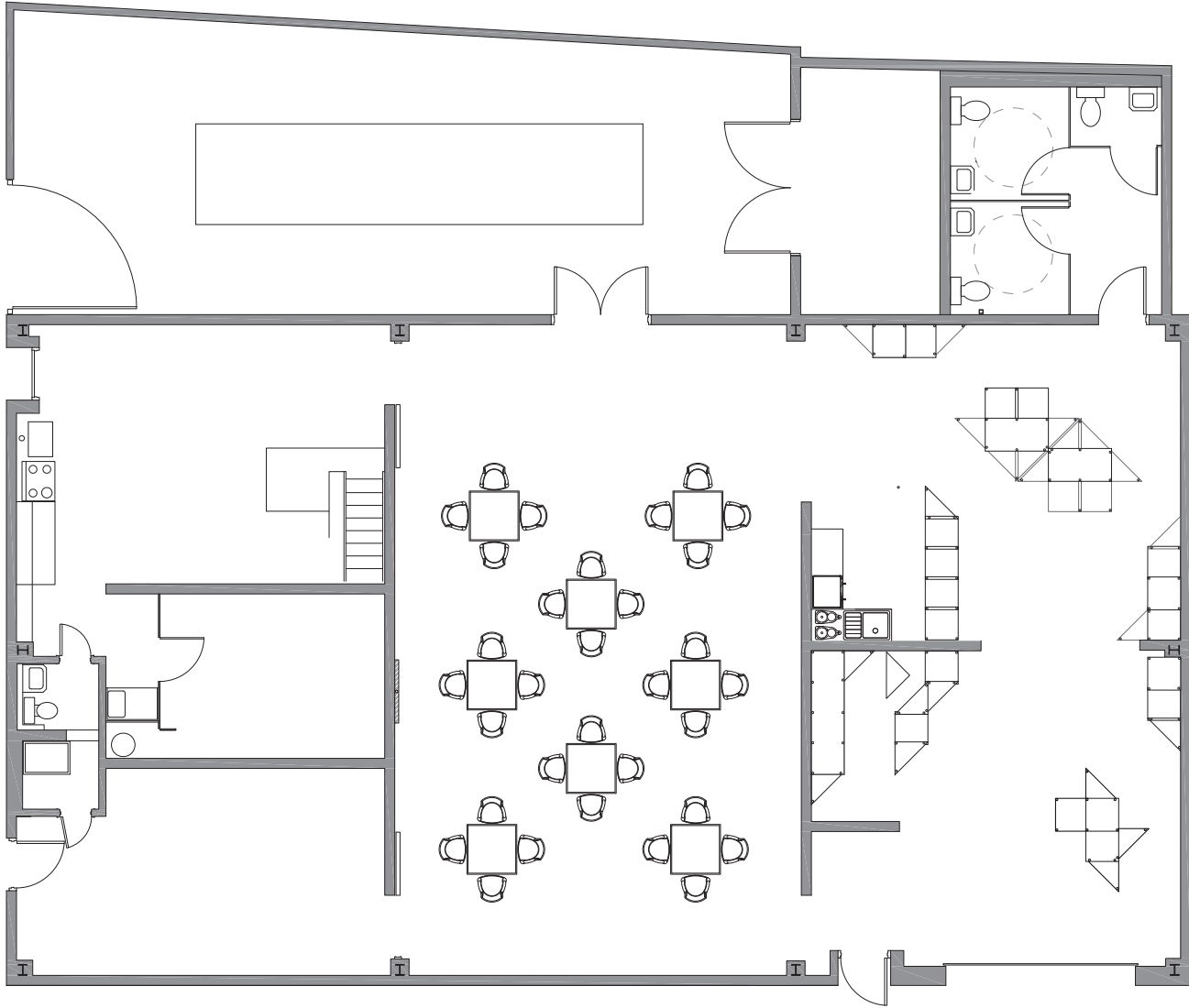

Showroom transformed into banquet hall, and outdoor space transformed into buffet area

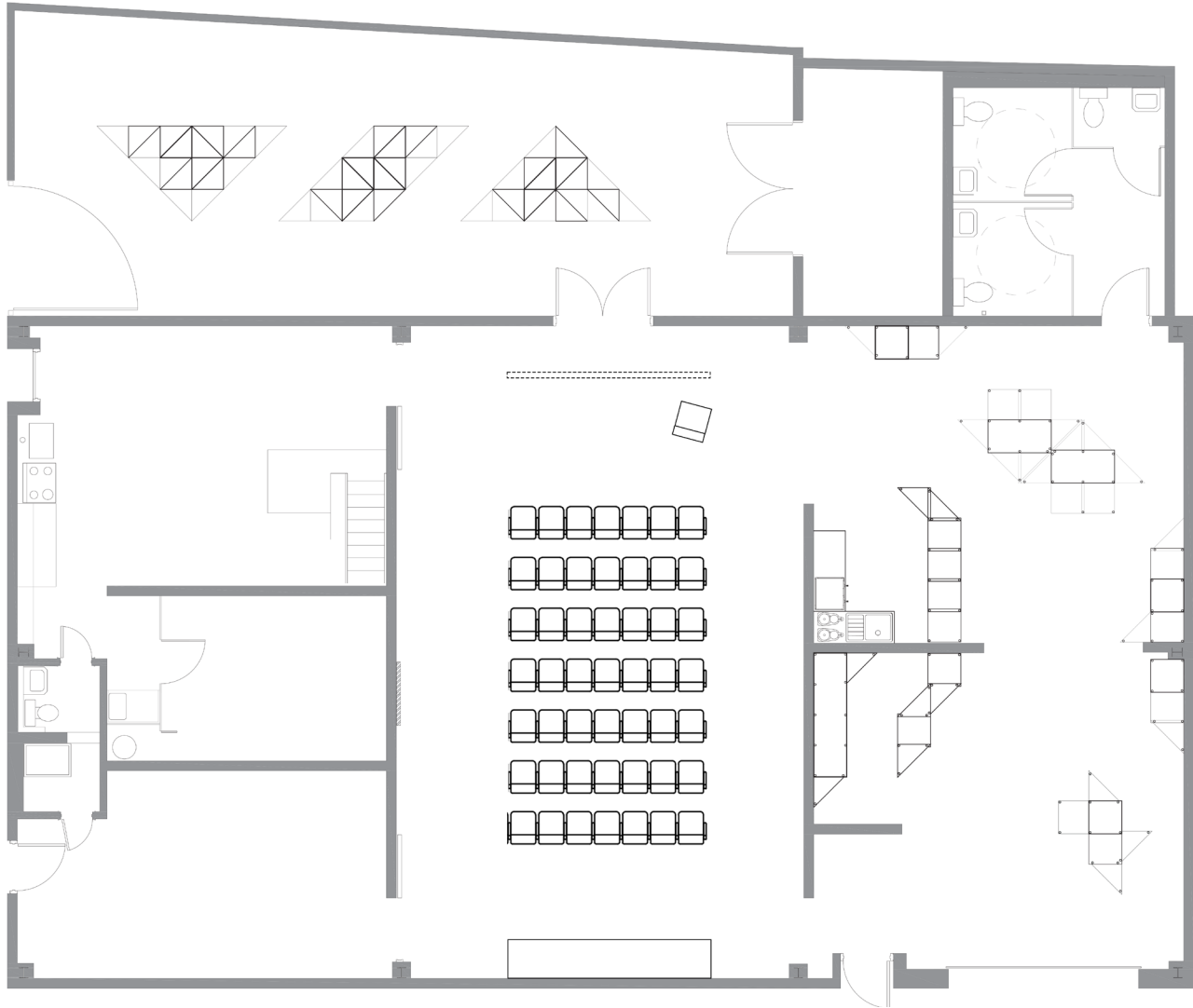

Showroom transformed into lecture hall

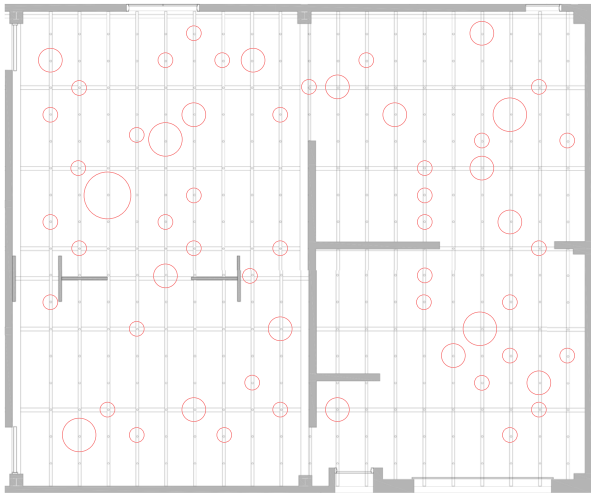

Distribution of ceiling akari (in RCP)